

## FOYER

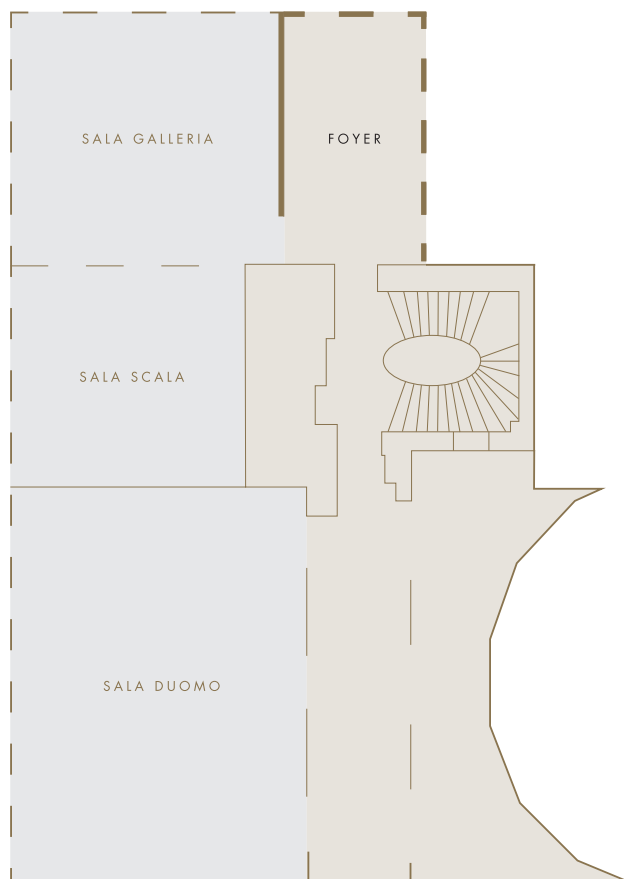

Located just outside the Galleria and Scala boardrooms, the Foyer can host up to 25 attendees in a cocktail reception-style setting, or it can also be used as a registration and welcome area.

---

Via Tommaso Grossi 1  
Milano, 20121, Italy  
[milan.park.hyatt.com](http://milan.park.hyatt.com)

T. +39 02 88 21 12 34  
F. +39 02 88 21 12 35

## SALA GALLERIA + SALA SCALA

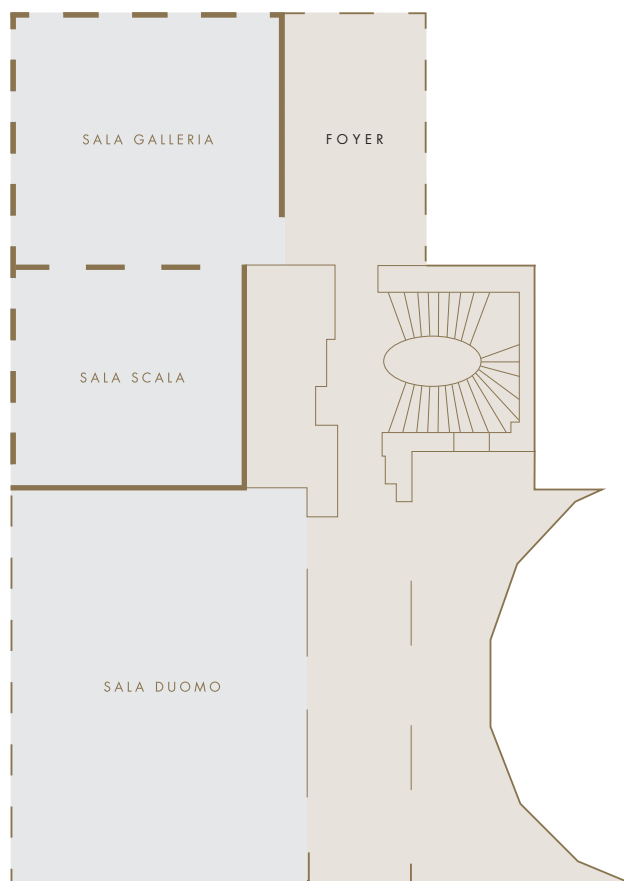

The Galleria boardroom, ideal for meetings and private business lunches, is a room of 48 square meters / 506 square feet, decorated with modern display cases in aluminum alloy and walnut wood, equipped with a sitting area with armchairs and access from a terracotta and apricot color-toned foyer. The Galleria boardroom can be connected to the Scala boardroom of 36 square meters / 388 square feet, outfitted as well with walnut furnishings: the union of the two rooms allows the creation of a single communicating environment yet with two secluded and separate spaces.

---

Via Tommaso Grossi 1  
Milano, 20121, Italy  
[milan.park.hyatt.com](http://milan.park.hyatt.com)

T. +39 02 88 21 12 34  
F. +39 02 88 21 12 35

## SALA DUOMO

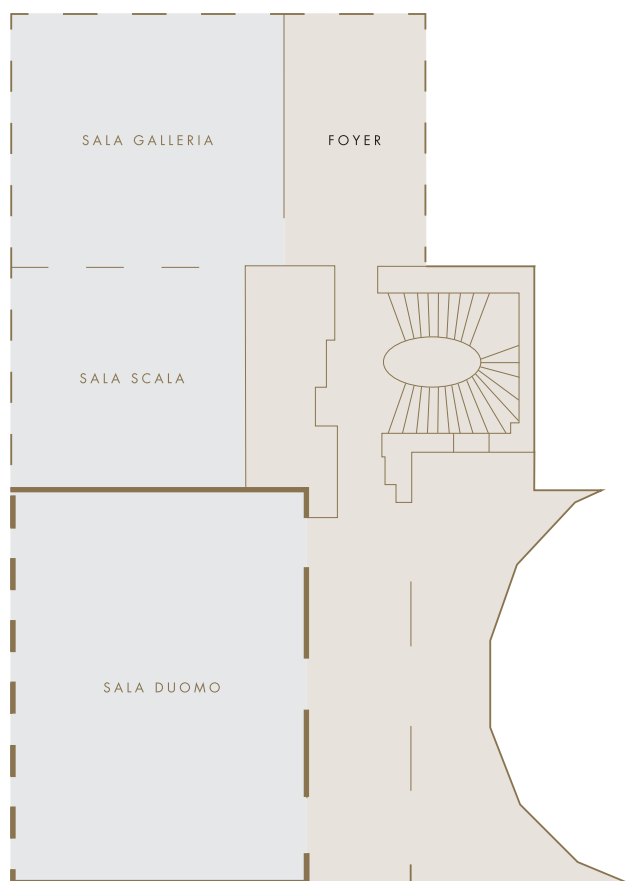

The Duomo meeting room is the largest, with an area of 96 sqm / 1033 sqft, perfect for receptions and dinners. It is furnished with fine walnut parquet flooring, mirrors and a vaulted ceiling in silver leaf.

---

Via Tommaso Grossi 1  
Milano, 20121, Italy  
[milan.park.hyatt.com](http://milan.park.hyatt.com)

T. +39 02 88 21 12 34  
F. +39 02 88 21 12 35