

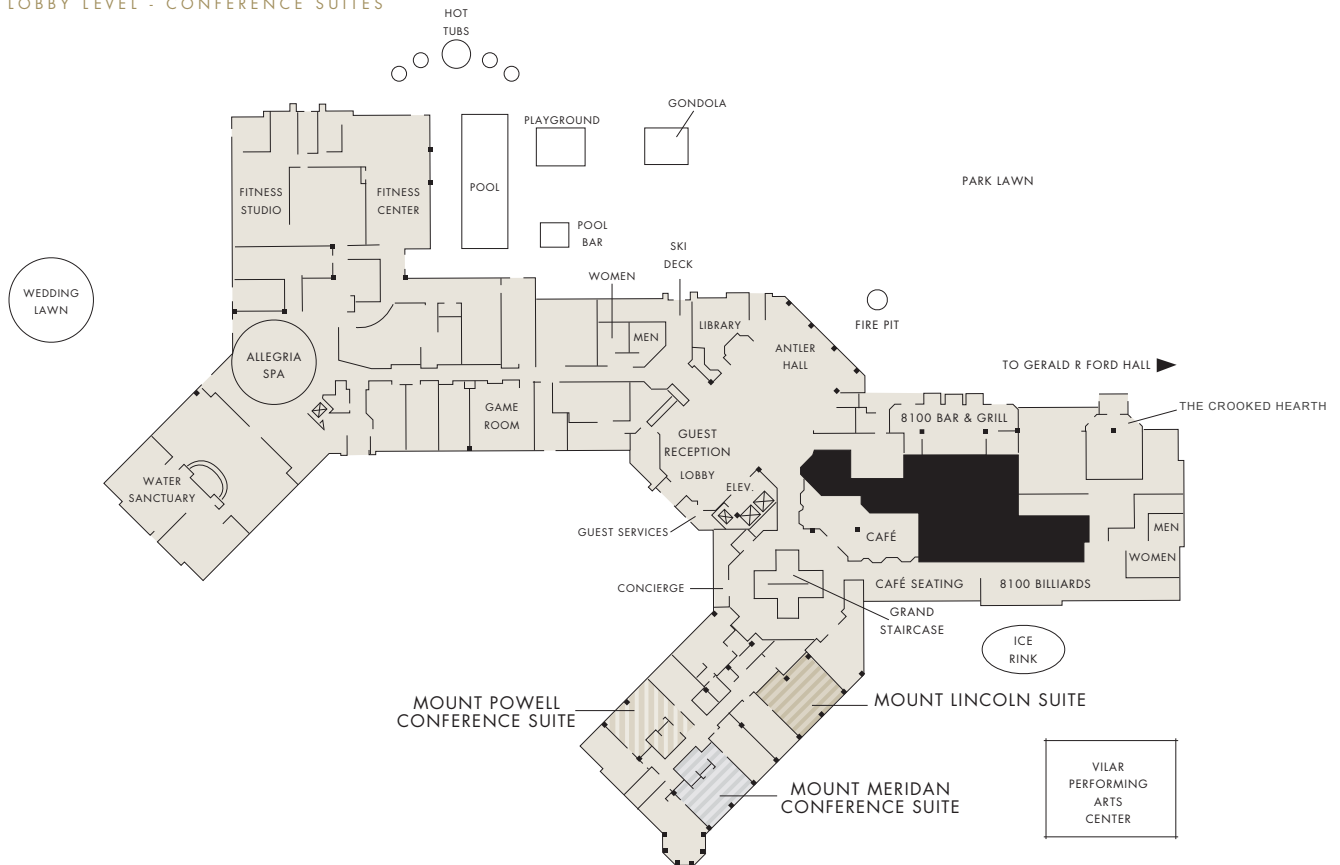

FLOOR PLAN & DIRECTIONS

HOTEL LOBBY LEVEL - CONFERENCE SUITES



DIRECTIONS

FROM DENVER INTERNATIONAL AIRPORT:

Exit the airport on Pena Boulevard and go 10 miles to Interstate 70. Enter I-70 westbound and go approximately 110 miles to Avon (Exit #167). Turn left (back under interstate) and go through the town of Avon. Enter the resort at the fifth roundabout. The guard on duty at the security booth can provide maps / directions to resort.

FROM VAIL / BEAVER CREEK JET CENTER (EAGLE):

Follow Interstate 70 eastbound approximately 25 miles to Avon (Exit #167). Turn right and go through the town of Avon. Enter the resort at the fifth roundabout. The guard on duty at the security booth can provide maps / directions to resort.



50 West Thomas Place
P.O. Box 1595
Beaver Creek, CO 81620, USA
parkhyattbeavercreek.com

T. +1 970 949 1234
F. +1 970 949 4164



FLOOR PLAN

HOTEL MEETING LEVEL

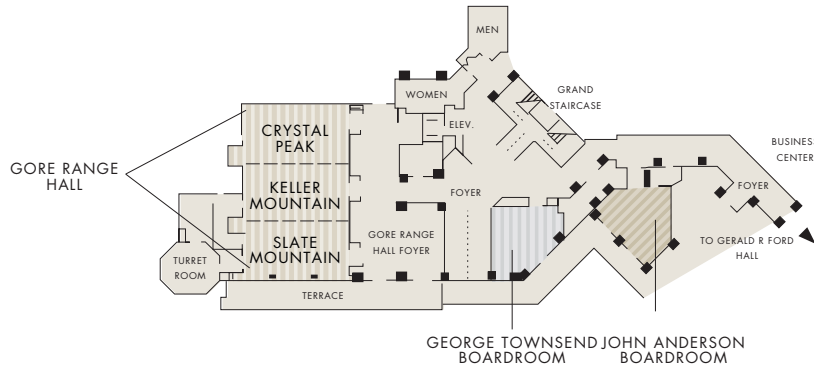

GERALD R. FORD HALL LOBBY LEVEL

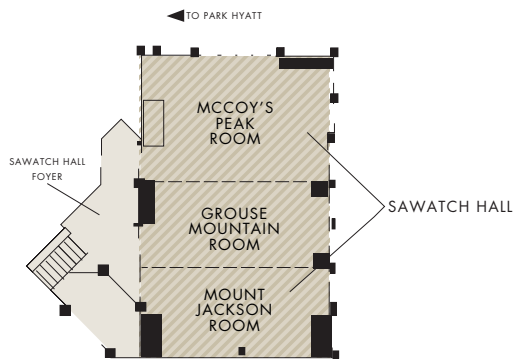

GERALD R. FORD HALL MEETING LEVEL

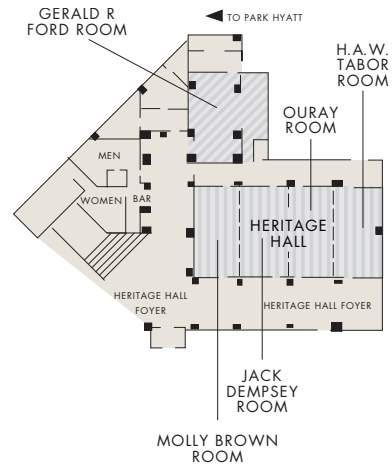

50 West Thomas Place
 P.O. Box 1595
 Beaver Creek, CO 81620, USA
 parkhyattbeavercreek.com

T. +1 970 949 1234
 F. +1 970 949 4164