

# FLOOR PLAN

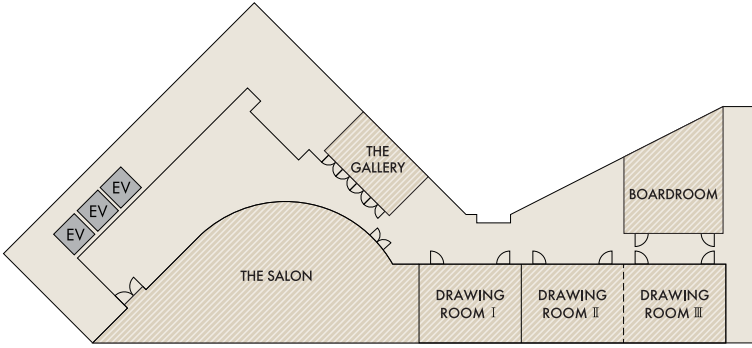

## ROOM DIMENSIONS & CAPACITIES

ROOM NAME	ROOM DIMENSIONS		SQUARE METER	BANQUET	COCKTAIL	THEATER	CLASSROOM	BOARDROOM	U-SHAPE
	<i>L x W x H (m)</i>	<i>sq m</i>							
THE SALON	21 x 9 x 3.5	158	90	120	90	60	20	24	
THE GALLERY	6 x 3.1 x 3.5	21	-	-	-	-	8	6	
BOARDROOM	7.5 x 7 x 3.5	52	-	-	-	-	12	-	
DRAWING ROOM I	6 x 5 x 3.5	36	10	20	24	12	10	10	
DRAWING ROOM II	6.3 x 5 x 3.5	39	10	20	28	14	10	10	
DRAWING ROOM III	6.3 x 5 x 3.5	39	10	20	28	14	10	10	
DRAWING ROOM II & III	12.6 x 5 x 3.5	78	30	60	54	30	28	24	

## MEETING FACILITIES

- Uniquely luxurious interior design in a modern residential style
- Floor-to-ceiling glass windows delivering full natural illumination and panoramic urban views
- Six event spaces offering ideal venues for diverse meetings and celebrations
- Built-in 180-inch LED media walls, LCD projectors and flatscreen monitors
- Ultra-high-speed Internet connections and state-of-the-art acoustic technology
- Customized event planning services from highly-experienced professionals

## DIRECTIONS

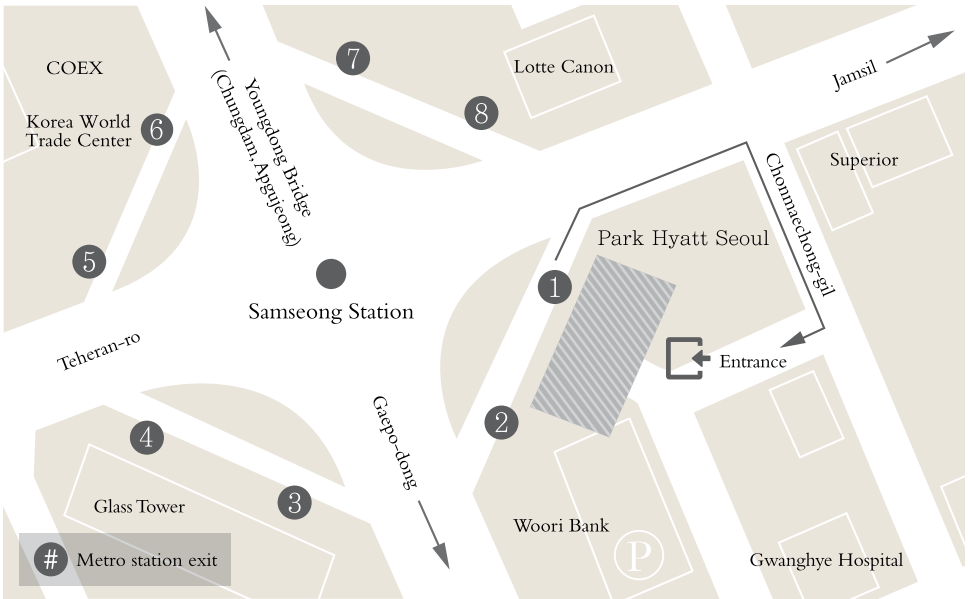

### PARK HYATT SEOUL

606, Teheran-ro, Gangnam-gu, Seoul, 06174, Korea

[parkhyattseoul.com](http://parkhyattseoul.com)

[seoul.park.hyattrestaurants.kr](http://seoul.park.hyattrestaurants.kr)

[facebook.com/parkhyattseoul](https://www.facebook.com/parkhyattseoul)

[@parkhyattseoul](https://www.instagram.com/parkhyattseoul)

T. +82 2 2016 1234

F. +82 2 2016 1200

### INFORMATION

T. +82 2 2016 1260